

EXTERNAL VENETIAN BLINDS - JALOUSIEN

- Exterior venetian blinds , type C-80 , Z-90 & Z70 , moving with crank or motor in 10 standard Ral colours
- They combine functionality with simultaneous sunshading , regulation of the incoming light and view to the exterior environment.



C-80



Z 70



Z 90



- **QUARANTIE : 2 years for the system, 5 years for the motor**
- **Wind resistance 36km/h (10m/s)**

ALFA ERGON EOOD

TECHNICAL CHARACTERISTICS

1.1 Stack of Slats Height

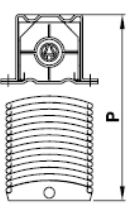
		P - STACK OF SLATS HEIGHT (cm)									
		C-80		C-80 CC		Z-90		Z-70		F-80	
		crank	motor	crank	motor	crank	motor	crank	motor	crank	motor
BLIND HEIGHT	50 - 75 cm	14	16	13	15	12	14	15	17	11.5	13,5
	76 - 100 cm	16	18	14	16	14	16	16	18	12.5	14.5
	101 - 125 cm	18	20	16	18	15	17	17	19	13	15
	126 - 150 cm	20	22	17	19	17	19	19	21	14	16
	151 - 175 cm	22	24	19	21	19	21	21	23	14.5	16.5
	176 - 200 cm	24	26	21	23	20	22	23	25	15.5	17.5
	201 - 225 cm	26	28	22	24	22	24	25	27	16	18
	226 - 250 cm	28	30	24	26	24	26	27	29	17	19
	251 - 275 cm	30	32	25	27	26	28	28	30	17.5	19.5
	276 - 300 cm	32	34	27	29	27	29	29	31	18.5	20.5
	301 - 325 cm	34	36	28	30	29	31	31	33	19	21
	326 - 350 cm	36	38	30	32	31	33	33	35	20	22
	351 - 375 cm	38	40	31	33	32	34	35	37	20.5	22.5
	376 - 400 cm	40	42	33	35	34	36	37	39	21	23

Note: The height of the stack of slats is an approximate value which can vary due to technical reasons.

1.2 Limiting Dimensions of Each Blind Type

blind types	operation type	min. width	max. width	max. height	max. area of 1 blind	max. width when connected		*max. area when connected
						operation on the side	operation in the middle	
C-80/C-80 CC	crank	50 cm	400 cm	400 cm	8 m ²	7 m	12 m	8 m ²
	motor	50 cm	400 cm	400 cm	16 m ²	7 m	12 m	36 m ²
Z-90	crank	50 cm	400 cm	400 cm	8 m ²	7 m	12 m	8 m ²
	motor	50 cm	400 cm	400 cm	16 m ²	7 m	12 m	36 m ²
Z-70	crank	50 cm	400 cm	400 cm	8 m ²	7 m	12 m	8 m ²
	motor	50 cm	400 cm	400 cm	16 m ²	7 m	12 m	36 m ²
F-80	crank	50 cm	350 cm	400 cm	8 m ²	7 m	12 m	12 m ²
	motor	50 cm	350 cm	400 cm	8 m ²	7 m	12 m	36 m ²
Self-supporting system	crank	50 cm	250 cm	400 cm	8 m ²	-	-	-
	motor	50 cm	250 cm	400 cm	10 m ²	-	-	-
EXT-50	cord	50 cm	250 cm	250 cm	5 m ²	3 m	-	5 m ²
	motor	60 cm	250 cm	250 cm	5 m ²	3 m	-	5 m ²
EXT-50 H	crank	50 cm	300 cm	400 cm	8 m ²	7 m	12 m	8 m ²
	motor	50 cm	300 cm	400 cm	8 m ²	7 m	12 m	25 m ²

* When blinds are connected, a deviation of max. 20° concerning the tilting of slats towards each other occurs.

Note: The side of operation is always determined from the interior.

ALFA ERGON EOOD

SHOW ROOM : Nikola Gabrovski 102A, (Studentski Grad), 1700 SOFIA
 TEL .02 44 37 220, 02 42 63 200 FAX 02 42 63 220
 Email: info@alfaergon.com www.alfaergon.com

6.5 Guide Rails and Brackets

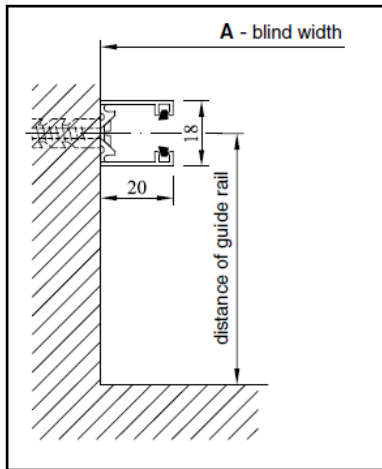

VL 1 - guide rail into the reveal

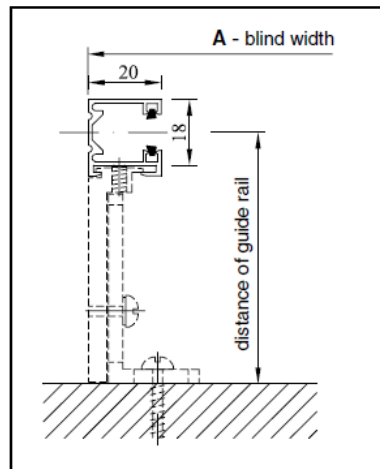

VL 2 - guide rail on the bracket

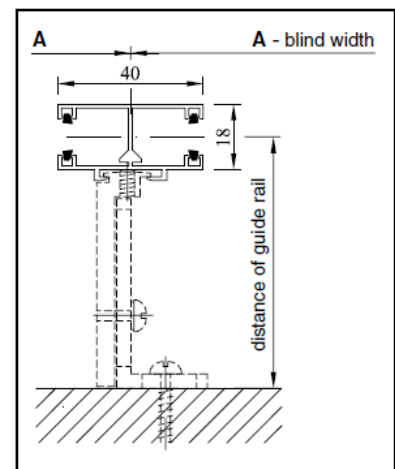

VL 3 - double guide rail

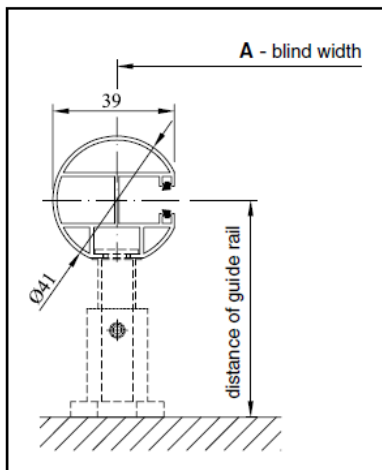

VL 4 - guide rail - round

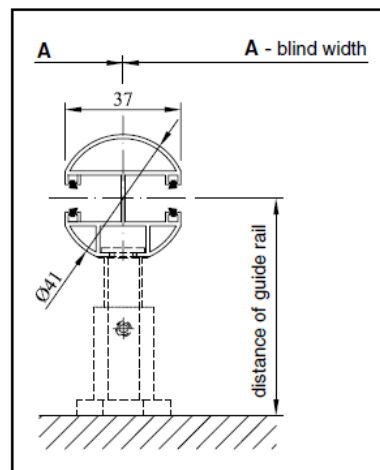

VL 5 - guide rail - round, double

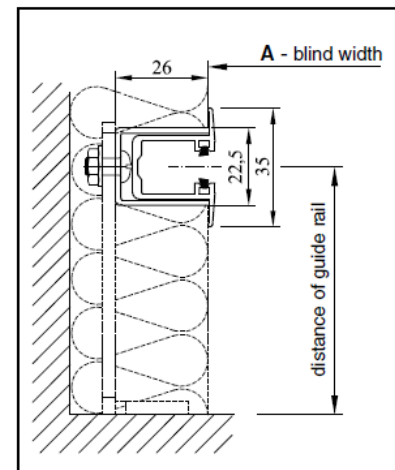

VL 7 - Built-in guide rail with built-in case ZP

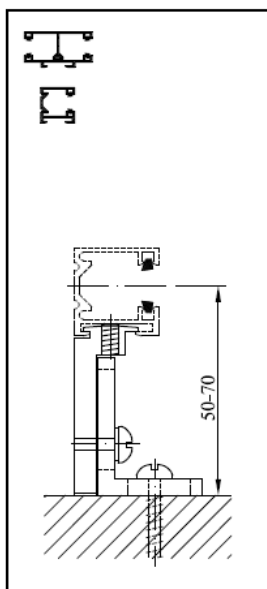

K 1 - guide rail bracket

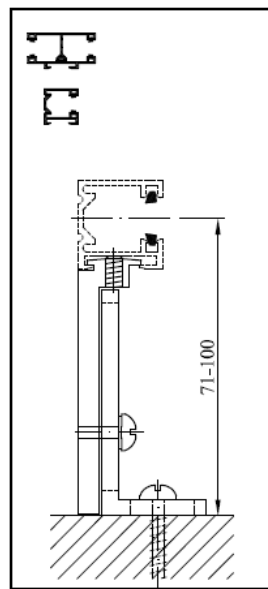

K 2 - guide rail bracket

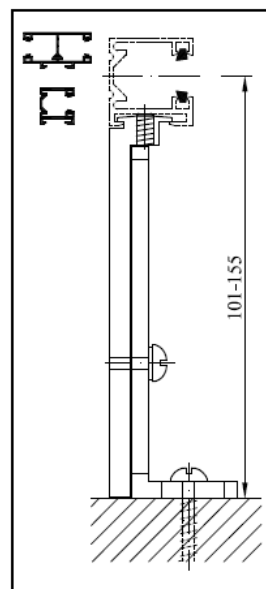

K 3 - guide rail bracket

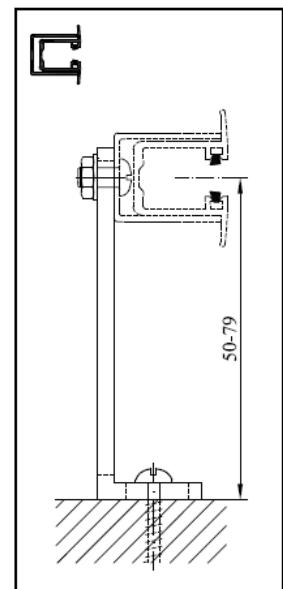

K 4 - Bracket for built-in case ZP

ALFA ERGON EOOD

SHOW ROOM : Nikola Gabrovski 102A, (Studentski Grad), 1700 SOFIA

TEL .02 44 37 220, 02 42 63 200 FAX 02 42 63 220

Email: info@alfaergon.com

www.alfaergon.com

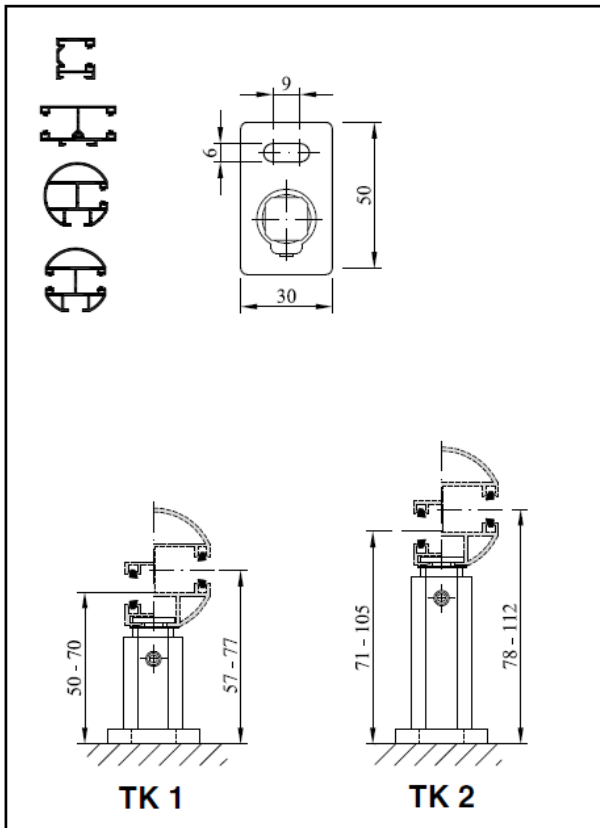

TK 1, TK 2 - telescopic guide rail bracket

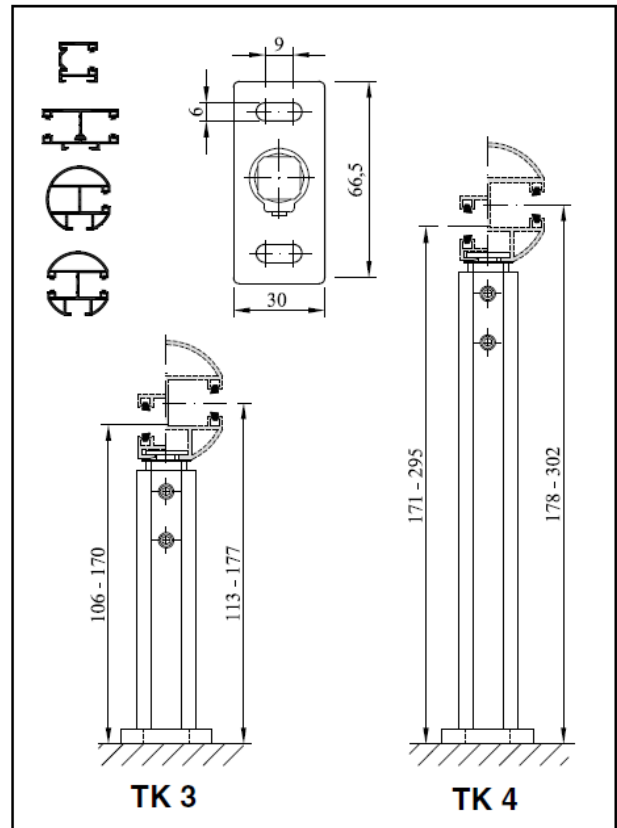

TK 3, TK 4 - telescopic guide rail bracket

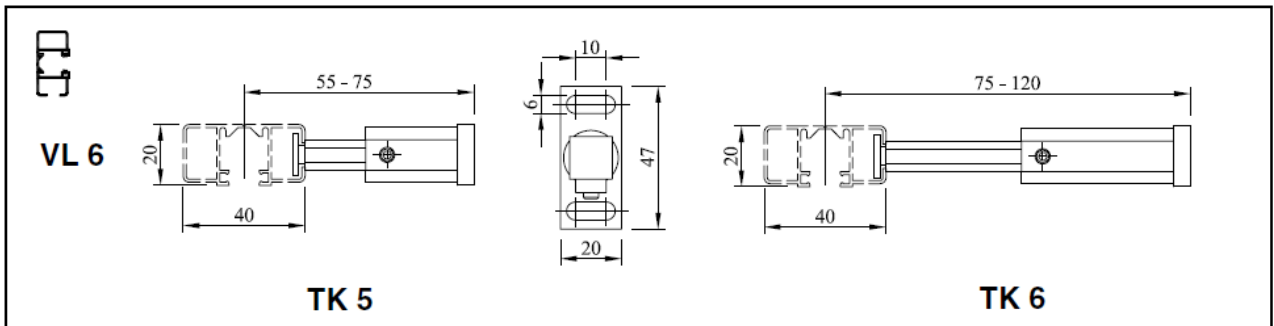

TK 5, TK 6 - telescopic bracket for self-supporting guide rail VL 6

6.6 Types of Wire Holders

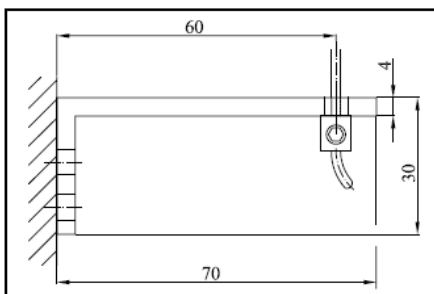

DL - wire holder standard

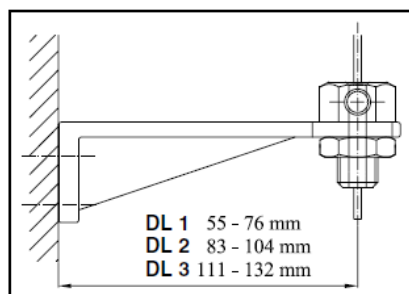

DL 1, DL 2, DL 3 - wire holder

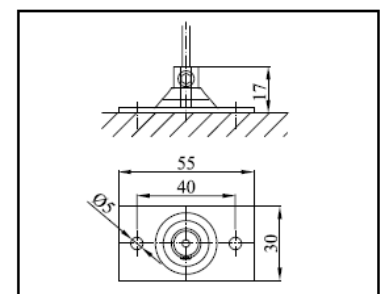

DL 4 - wire holder for anchoring into the floor

ALFA ERGON EOOD

SHOW ROOM : Nikola Gabrovski 102A, (Studentski Grad), 1700 SOFIA

TEL .02 44 37 220, 02 42 63 200 FAX 02 42 63 220

Email: info@alfaergon.com

www.alfaergon.com

6.7 Mounting Holders

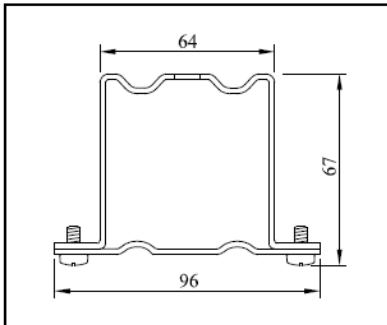

MD 1 - mounting holder standard

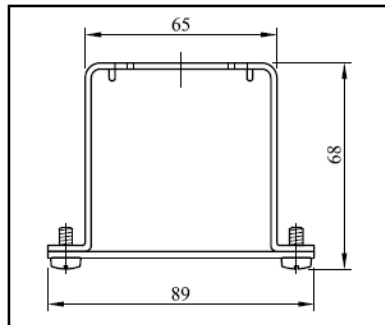

MD 1a - mounting holder - stainless steel

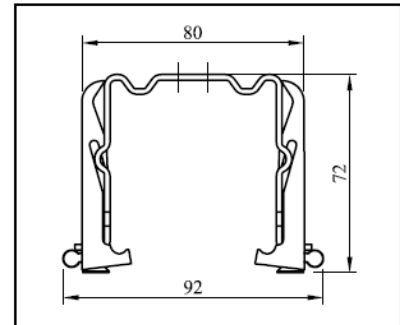

MD 1b - mounting holder - spring

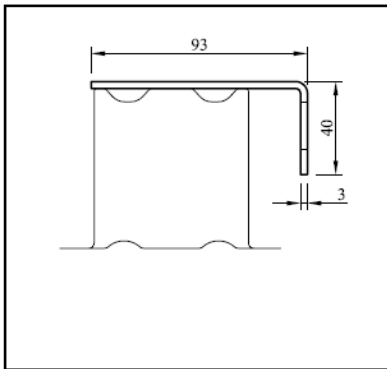

MD 2a - mounting holder on the frame

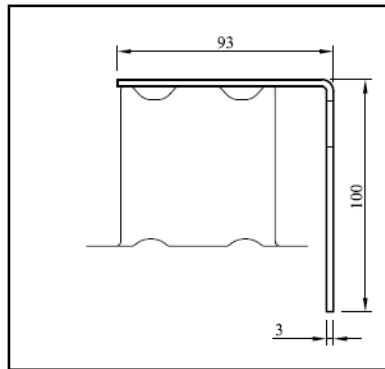

MD 2b - mounting holder on the wall

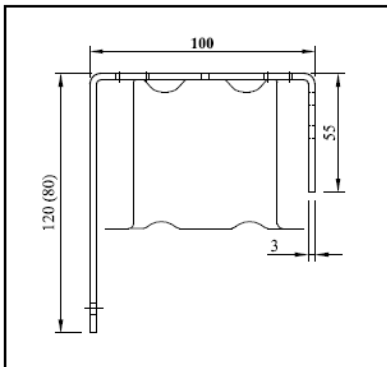

DK 2 - cover plate holder for Z-70, EXT-50 H

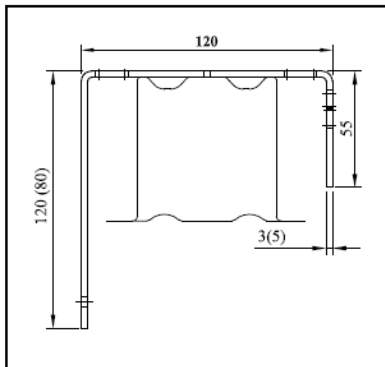

DK 3 - cover plate holder for C-80, Z-70, F-80

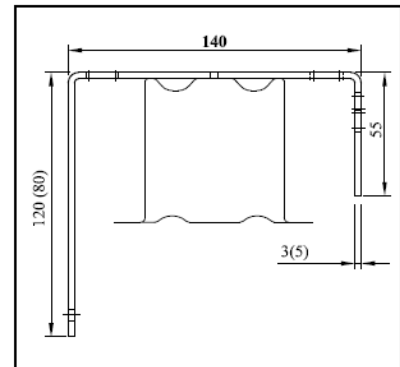

DK 4 - cover plate holder for Z-90

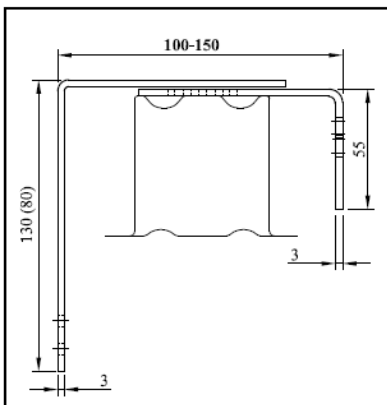

DK 5 - cover plate holder - sliding

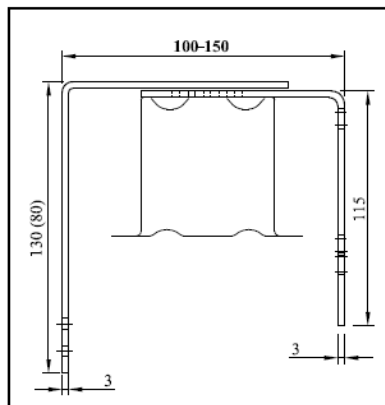

DK 5b - cover plate holder - sliding, enlarged

ALFA ERGON EOOD

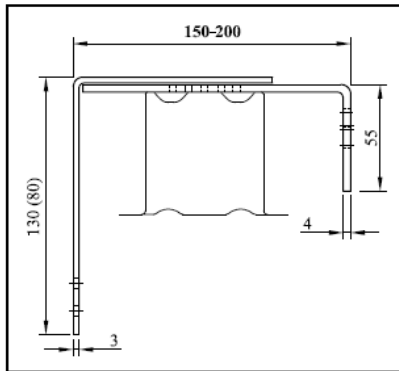

DK 6 - cover plate holder - sliding

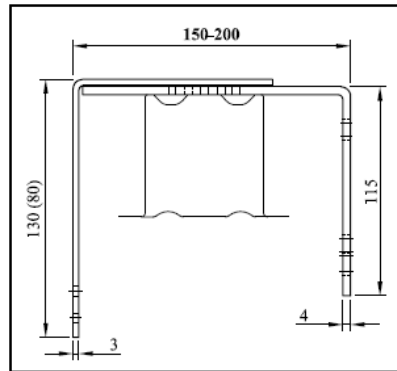

DK 6b - cover plate holder - sliding, enlarged

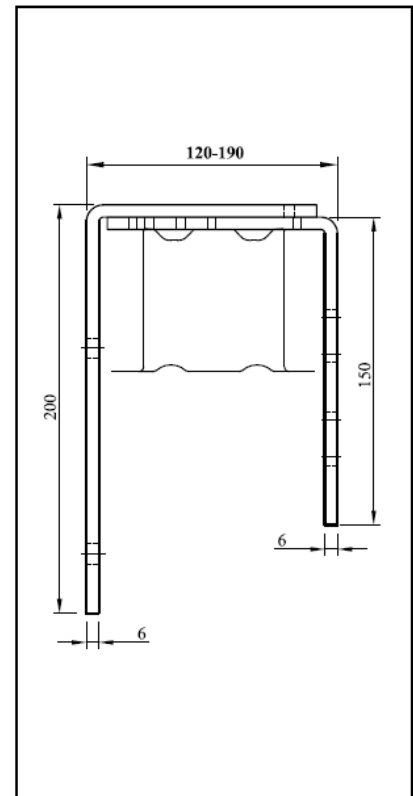

PP - cover plate holder - under-plaster, sliding

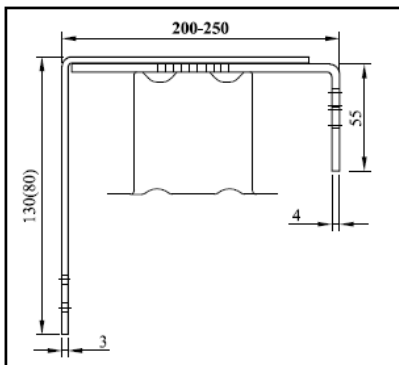

DK 7 - cover plate holder - sliding

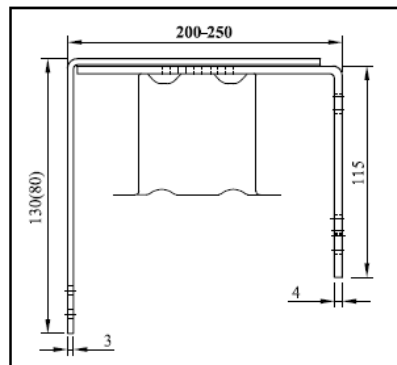

DK 7b - cover plate holder - sliding, enlarged

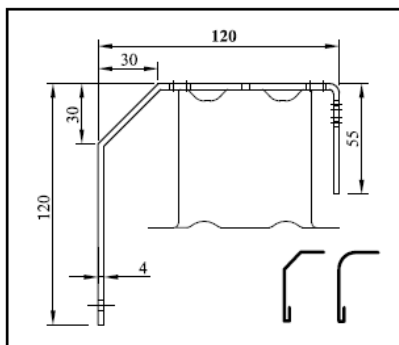

DK 3a - cover plate holder – bevelled for C-80, Z-70, F-80

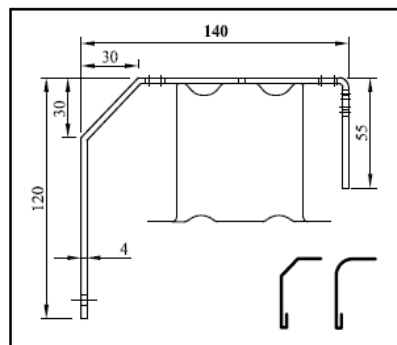

DK 4a - cover plate holder - bevelled for Z-90

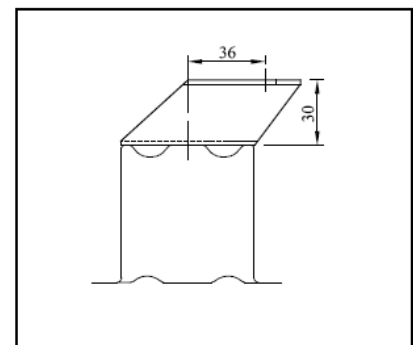

Z - holder into Heluz lintel

6.8 Selection of Extension size Depending on Cover Plate Height

VKP - height of angular cover plate (A)	extension type
	13.0 – 17.3 cm z
	17.4 – 25.3 cm a
	25.4 – 33.0 cm b
	33.1 – 41.2 cm c
	41.3 – 48.0 cm d

VKP - height of bevelled or half-round cover plate (A)	VKP(A) cannot be selected	extension type
	14.5 – 21.2 cm	z
	18.5 – 25.5 cm	a
	25.6 – 26.5 cm	b
	26.6 – 33.5 cm	c
	34.5 – 41.4 cm	c
	41.5 – 42.4 cm	c
42.5 – 48.0 cm	d	

ALFA ERGON EOOD

6.9 Types of Cover Plates and Side Parts

Legend: (N) - side part - riveted or enclosed (O) - side part - bent L - overall cover plate width

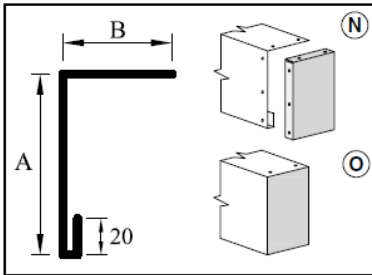

KP 1a $L = A + B$

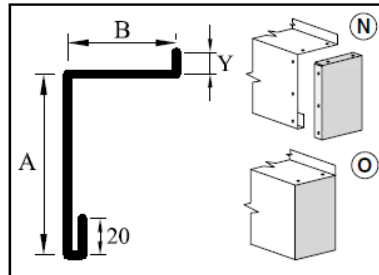

KP 2a $L = A + B + Y$

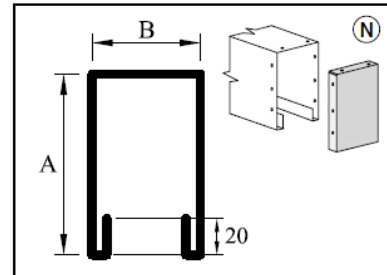

KP 3a $L = 2 \times A + B$

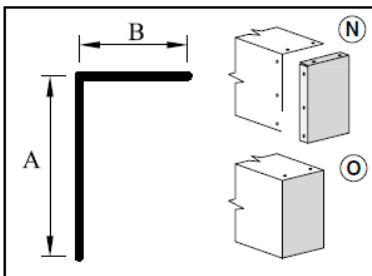

KP 1b $L = A + B$

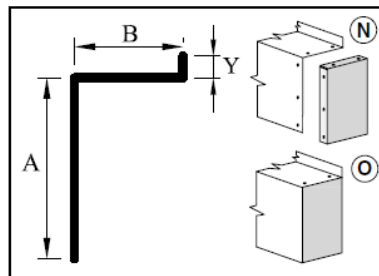

KP 2b $L = A + B + Y$

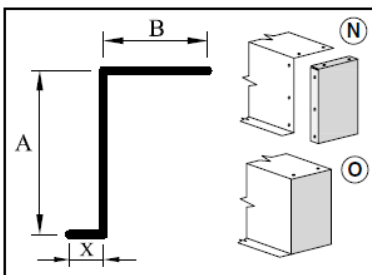

KP 1c $L = X + A + B$

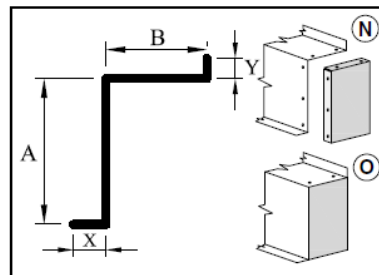

KP 2c $L = X + A + B + Y$

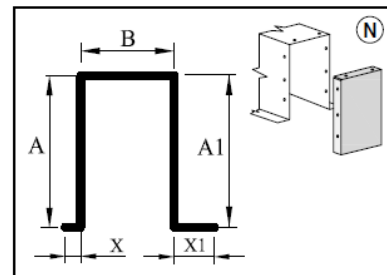

KP 3c $L = X + A + B + A1 + X1$

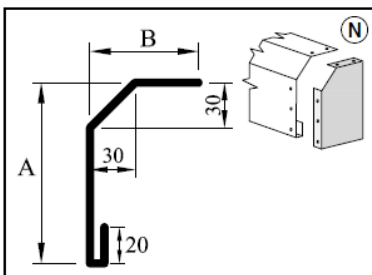

KP 1d $L = A + B$

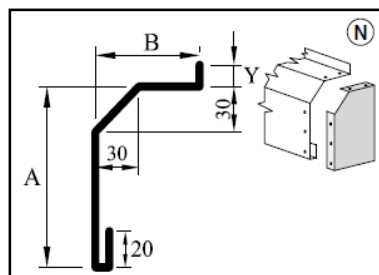

KP 2d $L = A + B + Y$

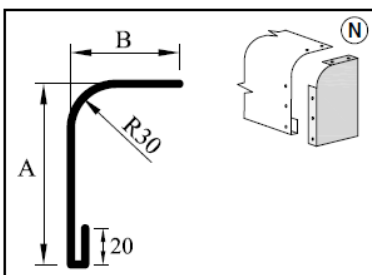

KP 1e $L = A + B$

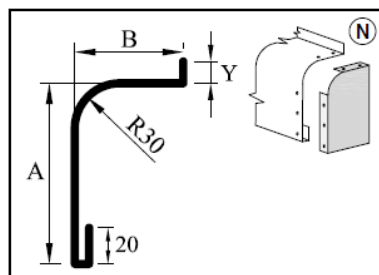

KP 2e $L = A + B + Y$

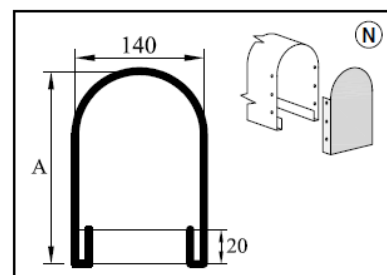

KP 3e $L = 2 \times A + 140$

ALFA ERGON EOOD

Standard Slat Colours

NUMBER	PAINT	DESCRIPTION	RAL	VSR	C-80	C-80 CC	Z-90	Z-70	F-80
010	H	white	9003	010	■	■	■	■	-
9010	H	white	9010	-	■	■	■	■	■
140	H	silver	9006	140	■	■	■	■	■
140	S	silver (structured)	9006	140	■	■	■	■	-
9007	H	grey (silver)	9007	907	■	■	■	■	■
130	H	grey	7038	130	■	■	■	-	-
240	H	light beige	-	240	■	■	■	-	-
7032	H	sage-green	7032	-	■	■	-	-	-
220	H	dark green	6005	220	■	■	■	-	-
906	H	blue	5002	906	■	■	■	-	-
071	H	brown (mahogany)	8016	071	■	■	■	-	-
905	H	black	9005	-	■	■	■	-	-
7016	H	black (anthracite)	7016	-	■	■	■	■	■

Legend: H - smooth paint S - structured paint ■ - standard colour without extra charge

Colour Harmonization of Components

SLAT NUMBER	TAPE COLOUR		LADDER COLOUR			
	C-80, C-80 CC, Z-90, Z-70	F-80	C-80 / C-80 CC	Z-90	Z-70	F-80
010	grey	-	white	grey	grey	-
9010	grey	grey	white	grey	grey	grey
140	grey	grey	grey	grey	grey	grey
140 S	grey	-	grey	grey	grey	-
9007	grey	grey	grey	grey	grey	grey
130	grey	-	grey	grey	-	-
240	grey	-	grey	grey	-	-
7032	grey	-	grey	-	-	-
220	grey	-	grey	grey	-	-
906	grey	-	grey	grey	-	-
071	grey	-	grey	grey	-	-
905	black	-	black	black	-	-
7016	black	grey	black	black	black	grey

Note: If you order a non-standard colour version, all components will be tuned in the grey colour.

- standard COLOURS H –smooth paint
- non-standard colours (extra charge) S – structured paint

ALFA ERGON EOOD

SHOW ROOM : Nikola Gabrovski 102A, (Studentski Grad), 1700 SOFIA
 TEL .02 44 37 220, 02 42 63 200 FAX 02 42 63 220
 Email: info@alfaergon.com www.alfaergon.com

Electric Connection

Building Readiness of Electric Installation

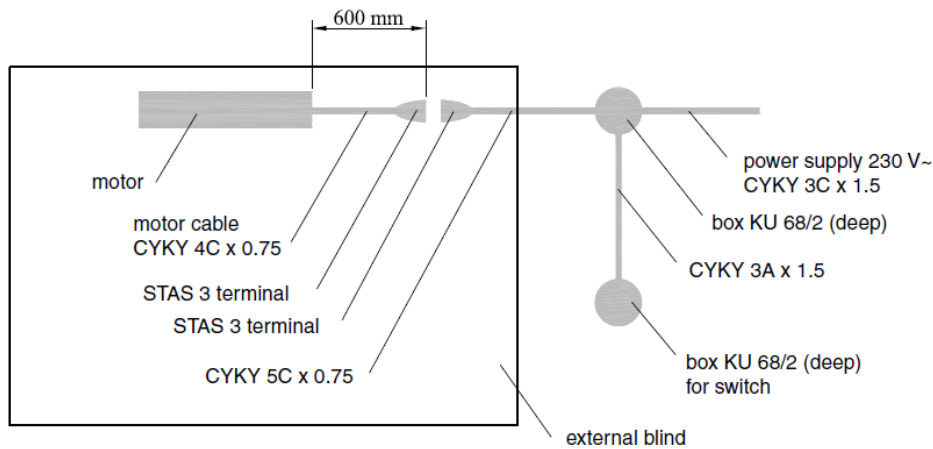

Motor and STAS Terminal Connection

- The supply cable 600 mm long is terminated with a STAS terminal.
- The connection shall be carried out by a skilled person.

DIAGRAM OF THE ELECTRIC MOTOR CONNECTION

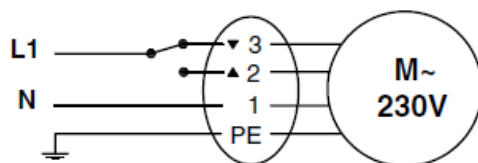

connector terminal
1 – blue neutral wire
2 – black hot wire
3 – brown hot wire
PE – yellow/green ground wire

DIAGRAM OF THE RECEIVER CONNECTION - Soliris ModulIs Slim Receiver RTS Plug

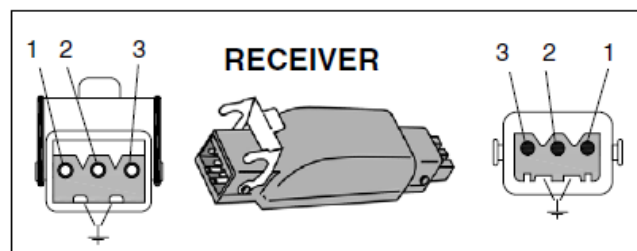
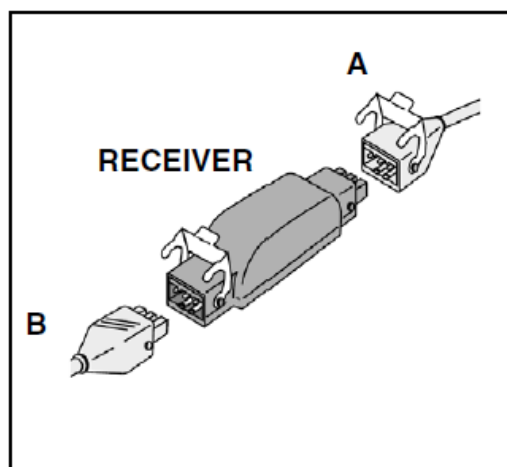

A - motor	connector terminal	B - supply
neutral wire	1	neutral wire
hot wire UP	2	hot wire
hot wire DOWN	3	(unoccupied)
ground wire	springs	ground wire

ALFA ERGON EOOD